

# Advent Security Portals



**Advent can help you protect your customers, employees, and valuables. An Isotec brand security portal will help prevent unauthorized entry by perpetrators with firearms and discourage robberies.**

## Features:

- Superior Quality
- ADA and Fire code compliant
- 1200 ft-lbs magnetic locks
- Concealed heavy duty door closers
- Support for up to Level III ballistic panels
- Tri-color touch screen control console
- On-screen diagnostics
- Powder coat finish with many color options
- Balance of security and throughput
- Modular and custom designs



## Benefits:

- Reduced physical threat
- Less Expensive than alternative solutions
- Eliminates contact with perpetrators
- Attractive architectural design
- Insurance cost savings
- Safe, Reliable and User Friendly
- Precision crafted
- Avoids trauma to customers and employees caused by armed robbery.

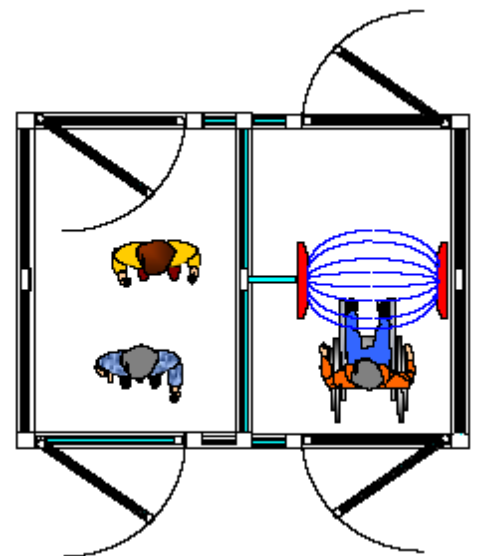

# Advent Security Portals

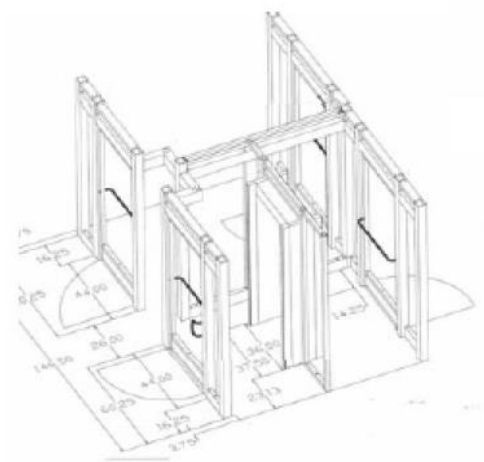

Concept Drawing

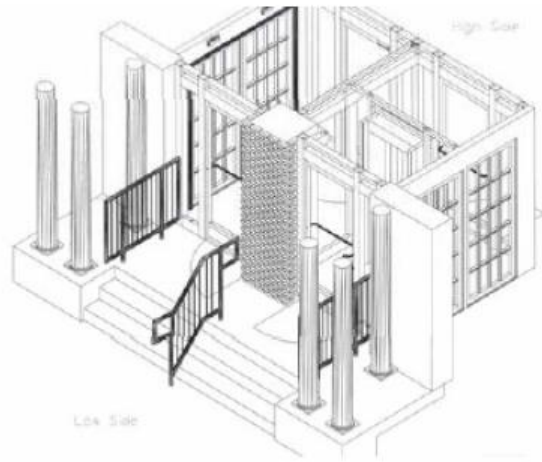

Isometric Drawing



Factory Construction



Installation

For more detailed information about Advent and our products and services please contact your Advent representative, visit us online at [www.advent-inc.com](http://www.advent-inc.com) or call at (301) 725-0737.



12011 Guilford Road, suite 103, Annapolis Junction, MD 20701 / (301) 725-0737